

TREX700 FLYBARLESS SYSTEM MOUNT UPGRADE
AT700-FSM (AL 6061-T6, ABS)

STEP 1

ASSEMBLE FLYBARLESS SYSTEM MOUNT UPGRADE ASSEMBLY

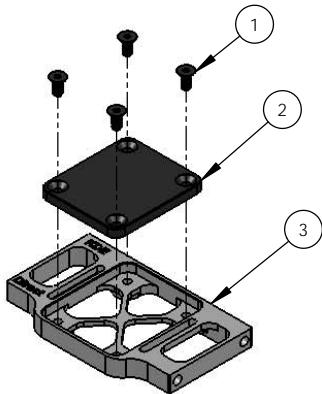

STEP 2

DRILL CARBON FRAMES FOR ACCURATE INSTALLATION
- ONLY REQUIRED FOR TREX 700E V1/V2 AND 800 DFC FRAME SET
- NO MODIFICATION NEEDED FOR TREX 700E DFC FRAME SET

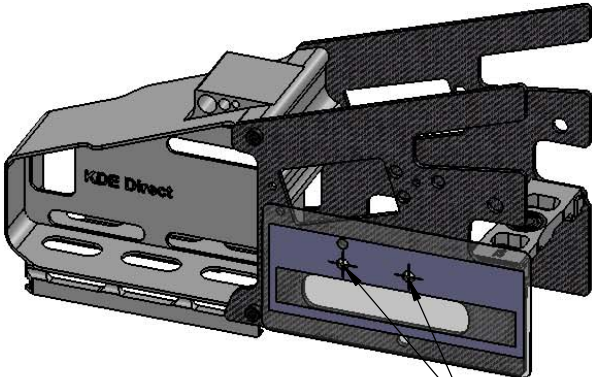

ATTACH ADHESIVE DRILLING TEMPLATE TO CARBON FRAMES (RIGHT AND LEFT SIDE INCLUDED) AND DRILL AT DUAL CROSSHAIR LOCATIONS TO 4.5MM. REPEAT BOTH SIDES.

STEP 3

INSTALL FLYBARLESS SYSTEM MOUNT UPGRADE ASSEMBLY

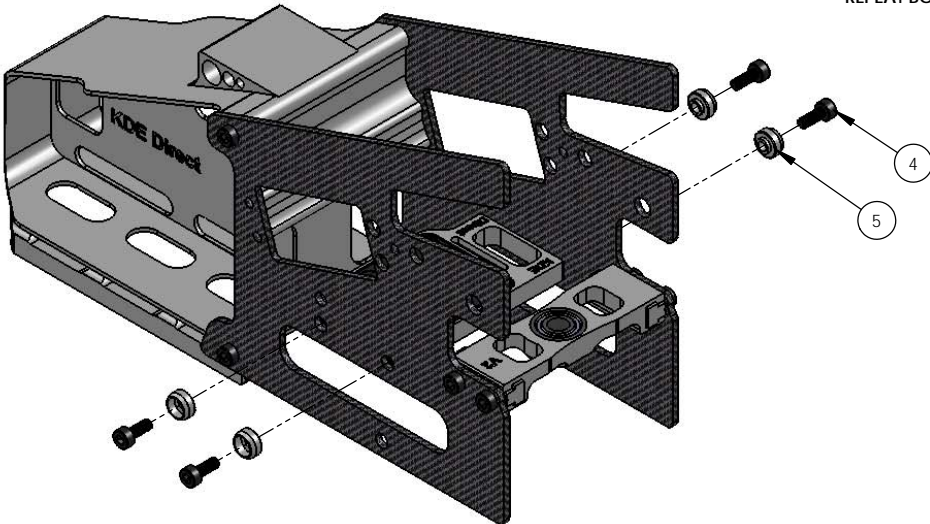

ITEM NO.	DESCRIPTION	QTY.
1	M2.5 x 0.45 x 6MM FLAT HEAD SOCKET HEAD CAP SCREWS (CLASS 12.9)	4
2	KDE DIRECT TREX 700/800 SERIES FLYBARLESS SYSTEM MOUNT ABS MOUNTING PLATE	1
3	KDE DIRECT TREX 700/800 SERIES FLYBARLESS SYSTEM MOUNT ALUMINUM BASE FRAME	1
4	M3 x 0.5 x 8MM SOCKET HEAD CAP SCREWS (CLASS 12.9)	4
5	M3 C-WASHERS, 4.5MM (AL 6061-T6)	4

NOTE: THE TREX 700/800 SERIES FLYBARLESS SYSTEM MOUNT PROVIDES THE IDEAL LOCATION FOR THE FLYBARLESS SYSTEM ELECTRONICS, WITH A LOCATION PROTECTED INTERNAL TO THE CARBON FRAMES AND CENTRALLY-ALIGNED TO THE HELICOPTER FOR OPTIMUM CONTROL. THE DESIGN USES AN ANTI-VIBRATION, ABS MOUNTING SURFACE FOR THE FLYBARLESS SYSTEM; SUPPORTED BY A LIGHTWEIGHT ALUMINUM 6061-T6 FRAME FOR ULTIMATE STRENGTH AND FLYBARLESS OPTIMIZATION.

STEP 1: ASSEMBLE THE FLYBARLESS SYSTEM MOUNT, USING THE INCLUDED FLAT HEAD SOCKET HEAD CAP SCREWS. MAKE SURE TO APPLY MEDIUM-STRENGTH LOCTITE (BLUE 243 OR EQUIVALENT) TO THE THREADS DURING INSTALLATION AND TIGHTEN FLUSH TO THE ABS MOUNTING PLATE.

FOR THE TREX 700E DFC HELICOPTER VERSION, STEP 2 IS NOT REQUIRED AND SKIP TO STEP 3 FOR FINAL INSTALLATION. HOLES ARE PRE-EXISTING IN THE 700E DFC FRAMES AND NO DRILLING/MODIFICATION IS REQUIRED.

STEP 2: CLEAR ADHESIVE DRILLING TEMPLATES ARE PROVIDED FOR THE TREX 700E V1/V2 AND 800 DFC CARBON FRAME SETS. ATTACH THE ADHESIVE DRILLING TEMPLATE (RIGHT AND LEFT SIDES PROVIDED) TO THE CARBON FRAMES, USING THE GEOMETRY AS A REFERENCE TO PROPERLY ALIGN THE CROSSHAIRS TO THE FRAMES. DRILL AT THE CROSSHAIR CENTERPOINT LOCATIONS TO 4.5MM AND REPEAT BOTH SIDES.

STEP 3: INSTALL THE FLYBARLESS SYSTEM MOUNT INTO THE FRAMES, USING THE INCLUDED SOCKET HEAD CAP SCREWS AND M3 C-WASHERS. APPLY MEDIUM-STRENGTH LOCTITE (BLUE 243 OR EQUIVALENT) TO THE THREADS DURING INSTALLATION AND HAND TIGHTEN SNUG TO THE FRAMES.

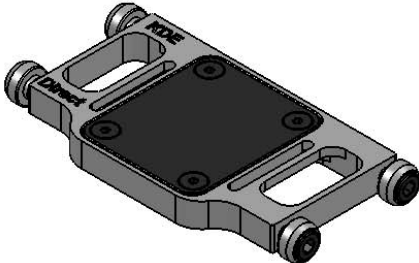

www.KDEDirect.com
AT700-FSM